

# Feel the **Power** of Control



Arrow®  
OnControl® Powered Bone Marrow  
Biopsy System

# In Control With OnControl®: Moving the Needle

The Arrow® OnControl® Powered Bone Marrow Biopsy System is an innovative, powered solution that raises the standard for biopsies and aspirations as compared to manual biopsy needles.

## For Practitioners

Provides increased control when accessing and extracting core specimens.<sup>1</sup>

## For Pathologists

More usable specimen area for diagnosis.<sup>1,2</sup>

## For Patients

Demonstrated to cause less pain during insertion and after the procedure, as compared to manual biopsy needles.<sup>1-4</sup>

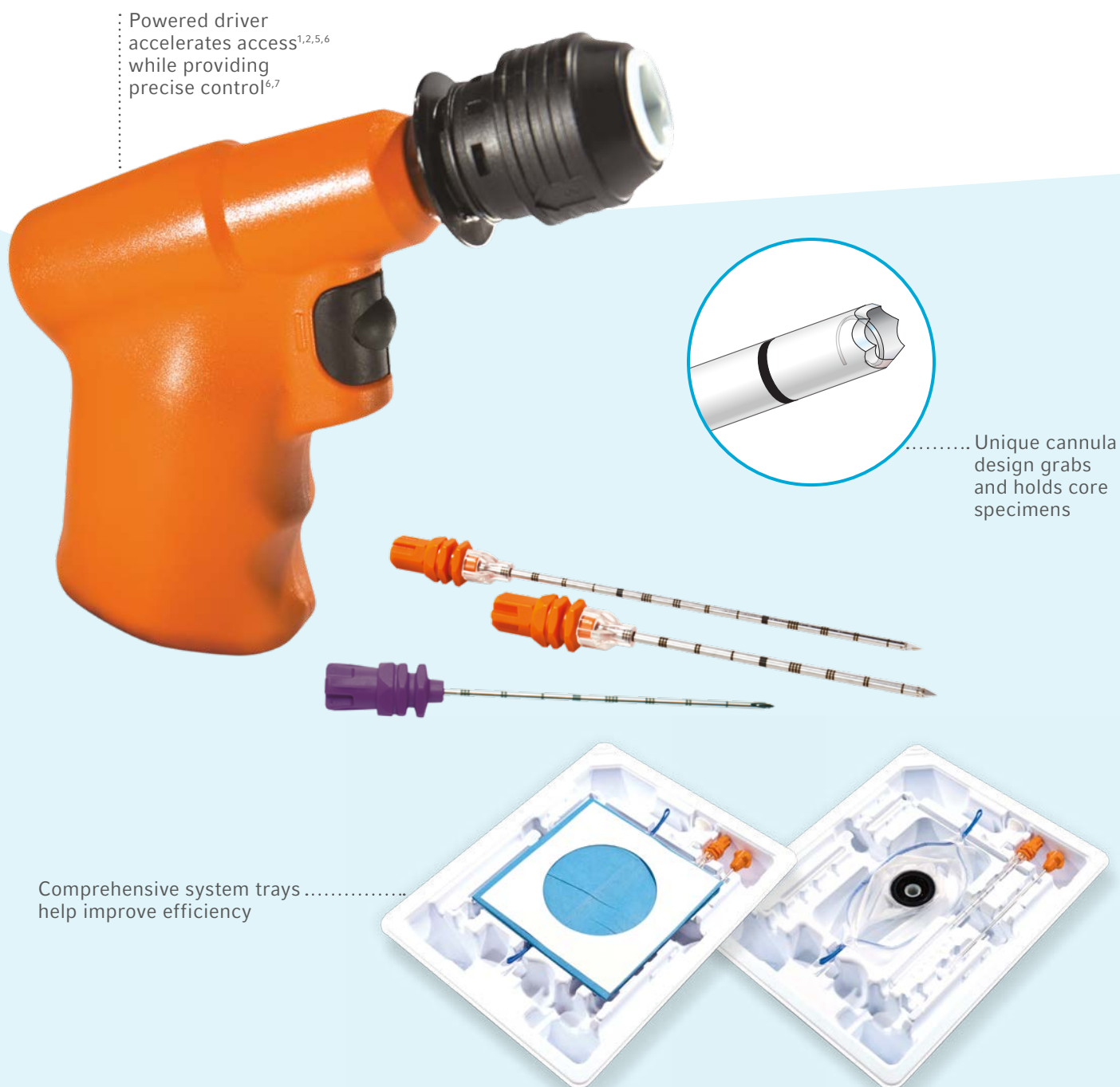

## High-Quality Samples

- As compared to manual biopsy needles, the Arrow® OnControl® Powered Bone Marrow Biopsy System has been shown to **deliver consistently larger, high-quality core specimens**.<sup>1,2</sup>
- This may **reduce the number of second-attempt procedures** required that can occur as a result of insufficient specimen size and may result in **more usable area** for diagnosis.<sup>1,2</sup>

Arrow® OnControl® System Core Specimen\*

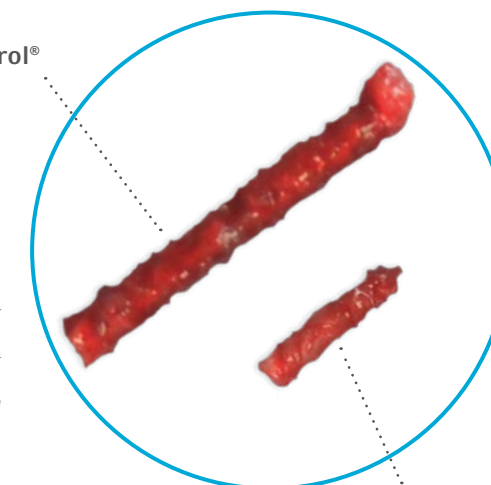

*\*Both specimen sizes from same healthy subject, same provider. Specimen sizes are most representative of specimen means in a published healthy subject study.*

Manual Biopsy Needle Core Specimen

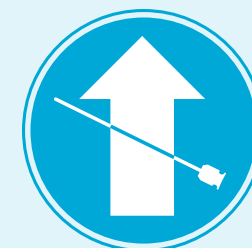

### Increased User Control<sup>4,5</sup>

- Helps to **effectively, safely, and rapidly** obtain specimens.<sup>1,2,5-7</sup>
- Easy to use, regardless of physical strength.
- May result in a procedure that is up to **55% faster** than with manual biopsy needles.<sup>1,2,4,8</sup>



### Dependable Performance

- Specially designed, threaded cannula **grabs and holds** core specimens.
- Comprehensive system trays contain the instruments needed for **multiple, high-quality bone biopsies** from a single penetration.



### Less Patient Pain

- Has been demonstrated to cause **less patient pain**, during insertion and after the procedure, as compared to manual biopsy needles.<sup>1-4</sup>
- Reduced pain can **help promote patient compliance** with ongoing testing.<sup>1</sup>

## We're With You Every Step of the Way

Backed by our experienced clinical training staff, the Arrow® OnControl® Powered Bone Marrow Biopsy System is raising the standard for biopsies and aspirations for cancer centers and interventional radiologists.

For more information or to request a demo, visit [OnControlSystem.com](http://OnControlSystem.com).

# Ordering Information

## Arrow® OnControl® Powered Bone Access

### Powered Driver

9401

### Bone Marrow Biopsy Trays

COMPREHENSIVE SYSTEM TRAYS, 11 GA	BIOPSY SYSTEM TRAYS, 11 GA
102mm 9458-VC-006	102mm 9408-VC-006
152mm 9451-VC-006	152mm 9411-VC-006

### Aspiration Needles

PORTED ASPIRATION TRAY, 11 GA	ASPIRATION NEEDLES, 15 GA
102mm 9471-VC-006	25mm 9425-VC-006
	68mm 9468-VC-006
	90mm 9490-VC-006

The Arrow® OnControl® Bone Marrow Aspiration and Biopsy Systems should only be used by clinicians familiar with the complications, limitations, indications, and contraindications of bone marrow aspiration and bone marrow biopsy. Rx only. Refer to instructions accompanying the device for indications, contraindications, warnings, and precautions.



### References:

1. Swords RT, Anguita J, Higgins RA, et al. A prospective randomized study of a rotary powered device (OnControl) for bone marrow aspiration and biopsy. *J Clin Pathol*. 2011;64(9):809-13. doi:10.1136/jclinpath-2011-200047. Research sponsored by Teleflex Incorporated.
2. Miller LJ, Philbeck TE, Montez DF, et al. Powered bone marrow biopsy procedures produce larger core specimens, with less pain, in less time than with standard manual devices. *Hematol Rep*. 2011;3(e8):22-5. doi:10.4081/hr.2011.e8. Research sponsored by Teleflex Incorporated. Philbeck TE and Montez DF are employees of Teleflex Incorporated.
3. Cohen SC, Gore JM. Evaluation of a powered intraosseous device for bone marrow sampling. *Anticancer Res*. 2008;28:3843-8. Research sponsored by Teleflex Incorporated.
4. Berenson JR, Yellin O, Blumenstein B, et al. Using a powered bone marrow biopsy system results in shorter procedures, causes less residual pain to adult patients, and yields larger specimens. *Diagnostic Pathology*. 2011;6:23. Research sponsored by Teleflex Incorporated.
5. Garcia G, Miller LJ, Philbeck TE, Bolleter S, Montez DF. Tactile feedback allows accurate insertion of a powered bone access device for vertebroplasty and bone marrow sampling procedures. *J Vasc and Interv Radiol*. 2011;22(3):S86. Research sponsored by Teleflex Incorporated. Philbeck TE and Montez DF are employees of Teleflex Incorporated. Dr. Garcia was formerly a paid consultant of Teleflex Incorporated. Simulated model study results may not be indicative of clinical performance.
6. Lee RK, Ng AW, Griffith JF. CT-guided bone biopsy with a battery-powered drill system: preliminary results. *AJR Am J Roentgenol*. 2013;201(5):1093-5. doi:10.2214/AJR.12.10521.
7. Symington K, Martinez F, Miller LJ, Philbeck TE. Examination of 64 consecutive specimens obtained using a powered biopsy device. *J Vasc and Interv Radiol*. 2014;25(3s):S196. Research sponsored by Teleflex Incorporated. Philbeck TE is an employee of Teleflex Incorporated.
8. Reed LJ, Raghupathy R, Strakhan M, et al. The OnControl bone marrow biopsy technique is superior to the standard manual technique for hematologists-in-training: a prospective, randomized comparison. *Hematol Rep*. 2011;3(e21). doi:10.4081/hr.2011.e21. Research sponsored by Teleflex Incorporated.

The Arrow® OnControl® Bone Marrow Aspiration System is intended for bone marrow aspiration of the iliac crest of adult and pediatric patients.

The Arrow® OnControl® Bone Marrow Biopsy System is intended for bone marrow core biopsy of the anterior or posterior iliac crest of adult patients.

The Arrow® OnControl® Powered Bone Marrow Biopsy System should not be used by clinicians unfamiliar with the complications, limitations, indications, and contraindications of bone marrow aspiration and biopsy.

Refer to the Instructions for Use for a complete listing of the indications, contraindications, warnings and precautions. Information in this material is not a substitute for the product Instructions for Use.

**CAUTION:** Federal (USA) law restricts this device to sale by or on the order of a physician. Not all products are available in all regions. Please contact customer service to confirm availability in your region. Refer to the Instructions for Use for a complete listing of the indications, contraindications, warnings and precautions.

Teleflex, the Teleflex logo, Arrow, and OnControl are trademarks or registered trademarks of Teleflex Incorporated or its affiliates, in the U.S. and/or other countries. All other trademarks are the marks of their respective owners.

Information in this document is not a substitute for the product Instructions for Use. The products in this document may not be available in all countries. Please contact your local representative. All data current at time of printing (07/2019). Subject to technical changes without further notice.

© 2019 Teleflex Incorporated. All rights reserved. MC-005570 Rev 0 Revised: 07/2019.