

ARROW PRESSURE INJECTABLE PICC

Expect more from your PICC

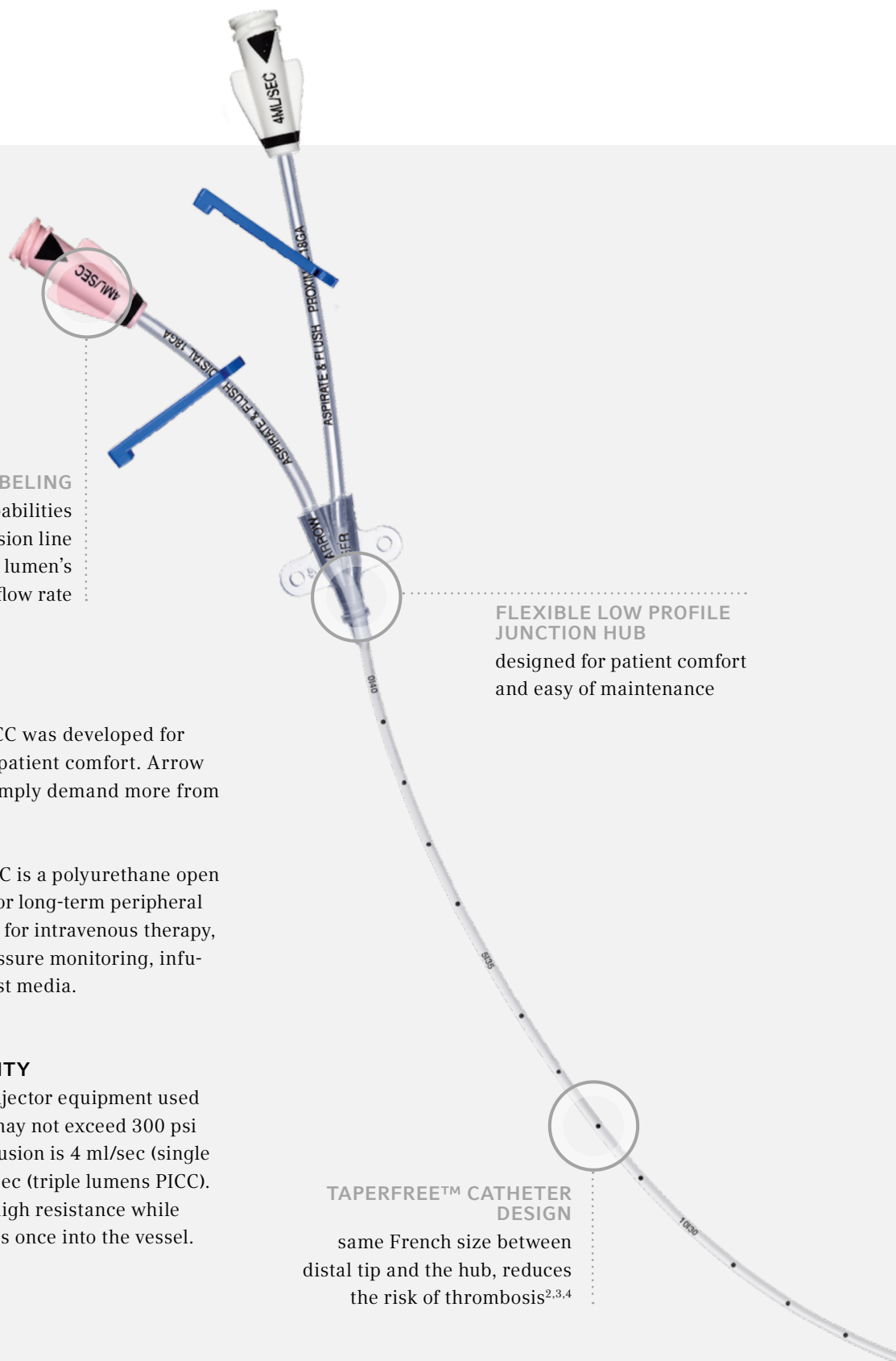

EXPECT MORE FROM YOUR PICC



DISTINCT LABELING
pressure injection capabilities
are marked on the extension line
hubs with each lumen's
maximum flow rate

**FLEXIBLE LOW PROFILE
JUNCTION HUB**
designed for patient comfort
and easy of maintenance

The ARROW Pressure Injectible PICC was developed for ease-of-use, smooth insertion and patient comfort. Arrow PICC is the choice for those who simply demand more from their PICC.

The ARROW Pressure Injectible PICC is a polyurethane open ended catheter, indicated for short or long-term peripheral access to the central venous system for intravenous therapy, blood sampling, central venous pressure monitoring, infusions and power injection of contrast media.

PRESSURE INJECTION CAPABILITY

The maximum pressure of power injector equipment used with the Pressure Injectible PICC may not exceed 300 psi while the maximum flow rate of infusion is 4 ml/sec (single and double lumens PICC) and 6ml/sec (triple lumens PICC). The ARROW Polyurethane ensures high resistance while maintaining softness and gentleness once into the vessel.

**TAPERFREE™ CATHETER
DESIGN**
same French size between
distal tip and the hub, reduces
the risk of thrombosis^{2,3,4}

CHOOSE THE RIGHT LENGTH, DO NOT TRIM THE TIP

The ARROW Pressure Injectable PICC is available in three different lengths (40, 50, 55 cm) thus eliminating the need to trim the line and avoiding to alter the integrity of the catheter itself. This means saving all the benefits related to the Blue Flex Tip and the Staggered Exit Ports.

BLUE FLEX TIP® & STAGGERED EXIT PORTS

The contoured design is softer than the rest of the catheter, which allows for smooth maneuvering through narrow, tortuous vessels with less trauma.

With this unique tip design, multi-lumen PICC's have staggered ports. These ports are intended to reduce the risk of medications mixing and creating a precipitate that could potentially occlude the catheter¹. The Blue Flex Tip® is also designed to track better over wire.

With the Blue Flex Tip, it is also the only PICC that can be inserted without a sheath in over-the-wire interventional insertions. It provides instant visual confirmation upon the removal.

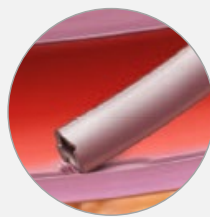

Blunt, ragged tip on conventional trimmable catheter poses risk of intimal trauma

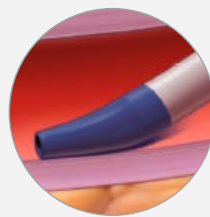

The soft, contoured tip is designed to be easier to maneuver and minimize trauma

BLUE FLEX TIP®

Unique to ARROW. Soft contoured tip design to enhance maneuverability while minimizing vessel trauma

STAGGERED EXIT PORTS

reduce the risk of mixing incompatible medications that can create precipitate¹

DOUBLE NUMBERING simplifies documentation of catheter length

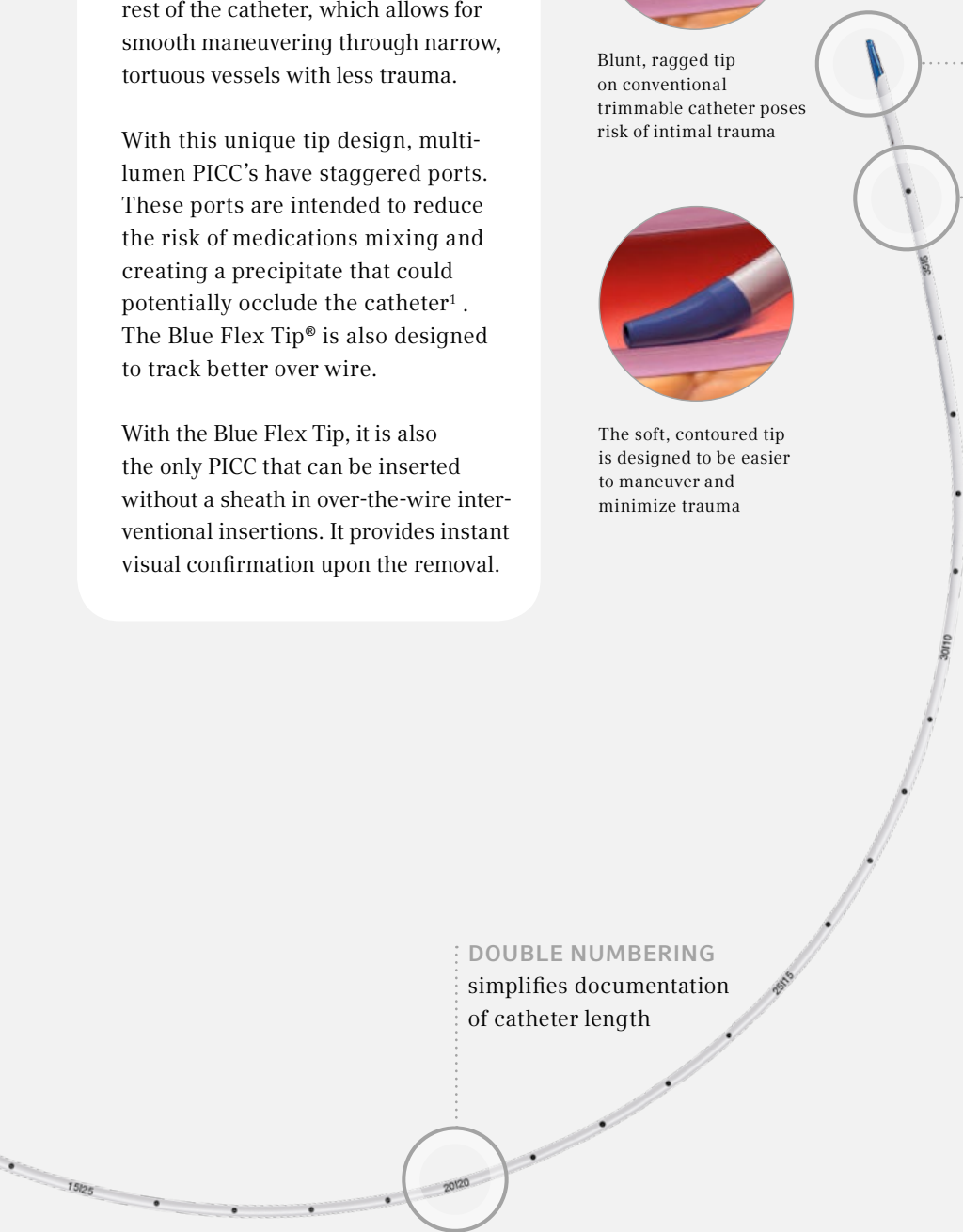

SAME SIZE FROM TIP TO HUB

Our attention to detail and focus on safety extends over the entire length of the catheter. ARROW PICCs are taper-free as we strive to make procedures complication-free. The ARROW TaperFree™ catheter design assures the clinician stated size is consistent between the distal and proximal

ends. Long tapered catheter bodies can be up to two French sizes larger than what's actually labeled⁵. This presents you with a catheter to vessel ratio that increases the risk of thrombosis^{2,3,4}.

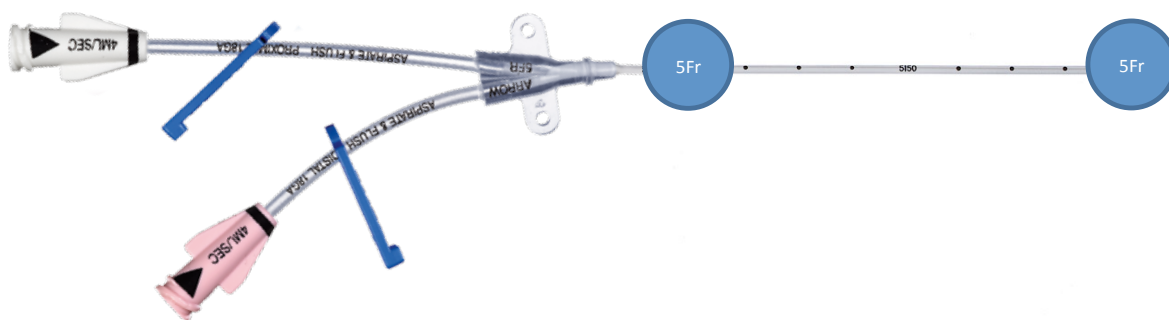

RISK OF THROMBOSIS RISES AS FRENCH SIZE INCREASES²

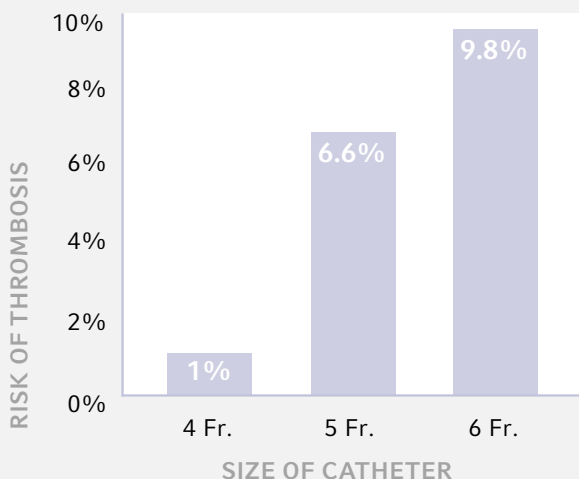

REVERSE FREE DESIGN

According to a study published in the Journal of Vascular and Interventional Radiology, the risk of thrombosis rises as French size increases³ (see chart). To minimize this risk, the authors recommend using the smallest acceptable catheter required for the therapy. With a tapered catheter body there can be a considerable difference between the French size at the tip and the French size at the proximal end. This type of design puts the widest portion of the catheter into the narrowest portion of the vein.

For the sake of their patients, clinicians need to know that the French size of their PICC does not vary. With ARROW PICCs you can depend on it. In fact, a study evaluating outcomes associated with a 6 French reverse tapered triple lumen PICC, was stopped prematurely due to unacceptably high venous thrombosis rate⁴.

1 Collins JL, Lutz RJ. In Vitro Study of Simultaneous Infusion of Incompatible Drugs in Multilumen Catheter. Heart & Lungs. 1991; 20(3):271-7

2 Nifong, T., McDevitt, T. The Effect on Catheter to Vein Ratio on Blood Flow Rates in a Simulated Model of Peripherally Inserted Central Venous. Chest 2011;140:48-53

3 Grove JR, Pevec WC. "Venous Thrombosis Related to Peripherally Inserted Central Catheters." Journal of Vascular and Interventional Radiology. 2000; 11: 837-840.

4 Trerotola, S., Stravropoulos, S., Mondeschein, J., Patel, A., Fishman, N., Fuchs, B., Kolansky, D., Kasner, S., Pryor, J., Chittams,

J. Triple-Lumen Peripherally Inserted Central Catheter in Patients in the Critical Care Unit: Prospective Evaluation. Radiology. 2010; 256 (1.2.)

5 Data on file

Teleflex is a leading global provider of specialty medical devices used for diagnostic and therapeutic procedures in critical care, urology and surgery. Our mission is to provide solutions that enable healthcare providers to improve outcomes and enhance patient and provider safety. We specialise in devices for general and regional anaesthesia, cardiac care, respiratory care, urology, vascular access and surgery and we serve healthcare providers in more than 150 countries. Teleflex also provides specialty products for medical device manufacturers.

Our well known brands include ARROW®, DEKNATEL®, GIBECK®, HUDSON RCI®, KMEDIC®, LMA™, PILLING®, PLEUR-EVAC®, RÜSCH®, SHERIDAN®, TAUT®, TFX OEM®, VASONOVA®, VIDACARE® and WECK®, all of which are trademarks or registered trademarks (in the U.S. and/or other countries) of Teleflex Incorporated.

Teleflex global operations: Australia, Austria, Belgium, Canada, China, Czech Republic, France, Germany, Greece, India, Ireland, Italy, Japan, Korea, Malaysia, Mexico, Netherlands, New Zealand, Portugal, Singapore, Slovak Republic, South Africa, Spain, Switzerland, United Kingdom, Uruguay and USA.

YOUR INTERNATIONAL CONTACTS:

TELEFLEX HEADQUARTERS INTERNATIONAL, IRELAND

Teleflex Medical Europe Ltd., IDA Business and Technology Park,
Dublin Road, Athlone, Co Westmeath
Phone +353 (0)9 06 46 08 00 · Fax +353 (0)14 37 07 73
orders.intl@teleflex.com

AUSTRALIA/NEW ZEALAND 1300 360 226

AUSTRIA +43 (0)1 402 47 72

BELGIUM +32 (0)2 333 24 60

CHINA (SHANGHAI) +86 (0)21 6163 0965

CHINA (BEIJING) +86 (0)10 6418 5699

CZECH REPUBLIC +420 (0)495 759 111

FRANCE +33 (0)5 62 18 79 40

GERMANY +49 (0)7151 406 0

GREECE +30 210 67 77 717

INDIA +91 (0)44-2836 5040

ITALY +39 0362 58 911

JAPAN +81 (0)3 3379 1511

KOREA +82 2 536 7550

NETHERLANDS +31 (0)88 00 215 00

PORTUGAL +351 22 541 90 85

SINGAPORE +65 6439 3000

SLOVAK REPUBLIC +421 (0)3377 254 28

SOUTH AFRICA +27 (0)11 807 4887

SPAIN +34 918 300 451

SWITZERLAND +41 (0)31 818 40 90

UNITED KINGDOM +44 (0)1494 53 27 61

For detailed information see www.teleflex.com

Teleflex is a registered trademark of Teleflex Incorporated or its affiliates.
The products in this catalogue may not be available in all countries. Please contact your local representative.
All data current at time of printing (11/2015). Subject to technical changes without further notice.
© 2015 Teleflex Incorporated. All rights reserved.

94 11 10 - 00 00 01 · REV A · MC / PDF · 11 15 PDF