



Arrow

Percutaneous Sheath Introducer Systems

Reliability counts

Teleflex - because reliability counts

Teleflex - high quality medical supplies - all from a single source

Teleflex is your strong cost-efficient partner with reliable brands. On the basis of solid tradition and with focus on patient safety, we apply all of our innovation capacity on supporting you to minimise risks and maximise treatment results for your patients. Therefore, we have developed a unique product portfolio based on your requirements.

As a leading manufacturer of high-quality medical products we, Teleflex, are at your disposal worldwide and at any time.

Venous sheaths for the insertion of PA/TD catheters are subject to very high safety standards. With its Arrow products, Teleflex sets benchmarks in this field. We help you undertake life-saving treatments while adhering to important health directives.

You can find further details and technical specifications of our products within this brochure.

Introducer systems for all types of venous access

With our modern Arrow brand state-of-the-art introducer sets, you are optimally equipped in critical situations in the OR, as well as, in the ICU.

Single-lumen percutaneous introducer sets (PSI) for venous access are used for the insertion of pulmonary artery and thermodilution catheters (PA or TD catheters).

PSI, as well as MAC systems, may be used for the insertion of longer catheters and for the infusion of high-volume solutions.

Multi-access catheters (MAC) provide the advantage of multiple extension lines, for central venous patient care, with just one puncture site.

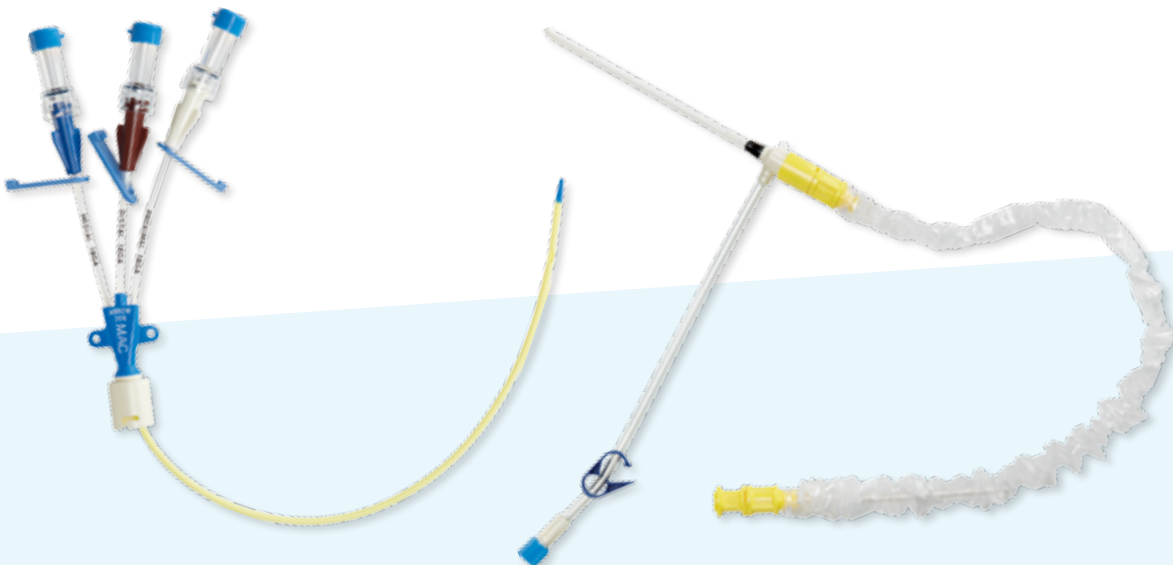

Customised sets

Standardizing your process



With options one step ahead

As part of the European Arrow Selection Kits (EASK) programme, you can individually compile and order your own sets from us. You can obtain further details from your Teleflex representative.

Time-saving, higher efficiency and less waste

Customized to suit your needs and preferences, upon request we will compile your set just the way you want it to care for your patients in the best possible way.

The European Arrow Select Kits (EASK) guarantee a perfect combination of safety compliance, simple application and economy.

EASK simplifies purchasing and reduces the storage capacity necessary for a particular procedure to a single set. There is no longer any need to stock additional components that are often not part of a standard set.

EASK European Arrow Select Kits

- Efficient, economical & ecological – save time and expense and prevent waste
- Adapted to your internal processes and preferences
- Improves patient and user safety

One program specifically to meet your needs

Teleflex has a multi-functional team of EASK specialists who focus on the processing and despatch of your EASK orders. If you wish, our EASK team will undertake a non-obligatory analysis to find the best product configuration for your customised set because we would like to meet your requirements to your complete satisfaction.

Introducer systems for all types of venous access

| | |
|---|-----|
| PSI standard percutaneous sheath introducers..... | 4/6 |
| MAC multi-lumen access catheters..... | 5/7 |
| Accessories..... | 7 |

Standard percutaneous sheath introducer sets (PSI)

For the pulmonary artery and central venous access

Our single-lumen percutaneous sheath introducer sets allow simple puncturing and safe insertion via a guidewire (according to Seldinger). The sheath is made of polyurethane which becomes softer in situ. In the event that the insertion of a catheter via the sheath is delayed, the haemostasis valve and the locking obturator prevent back bleeding and reduce the risk of air embolisms.

The flexible part of the sheath on the hemostasis valve has been developed to prevent kinking, e.g. when inserting a pulmonary artery catheter. It also ensures optimum hold, e.g. when inserting a pulmonary artery catheter. On the other hand, the Cath-Gard catheter protection shield assists in allowing the catheter to be manipulated at any time without the risk of contamination.

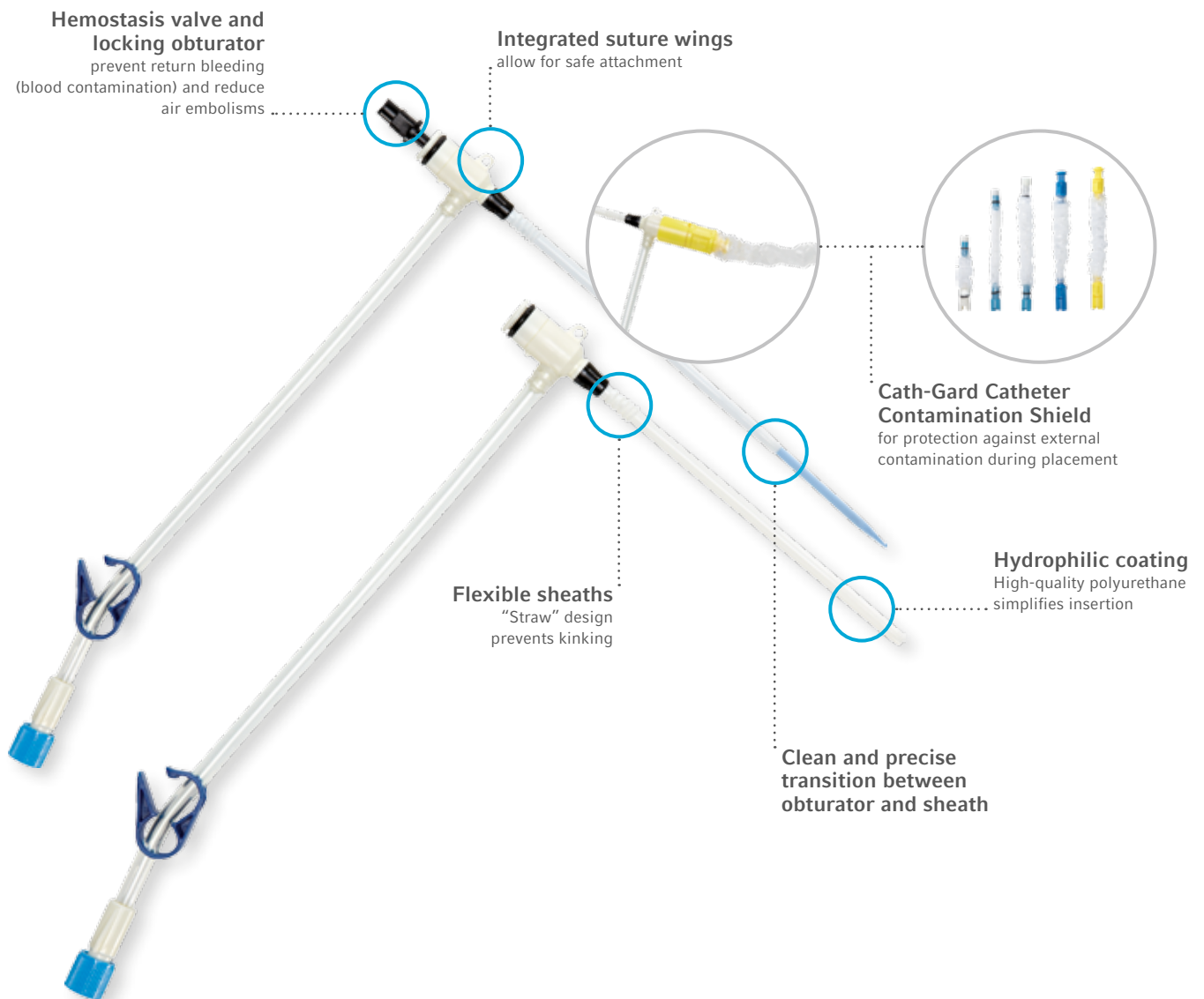

MAC - multi-lumen access catheters

A great breakthrough with even more versatility

The Arrow MAC (multi-lumen access catheter) can be used as a sheath for placing a TD catheter or for dispensing fluid at high flow rates. Such high flow rates, as are often necessary during major operations, can be kept reliable and constant with our MAC even when concurrent haemodynamic monitoring is required.

Arrow's multi-lumen catheters are made of the highest quality materials. Extremely smooth insertion and great kink resistance make them one of the most reliable sheath products currently available on the market.

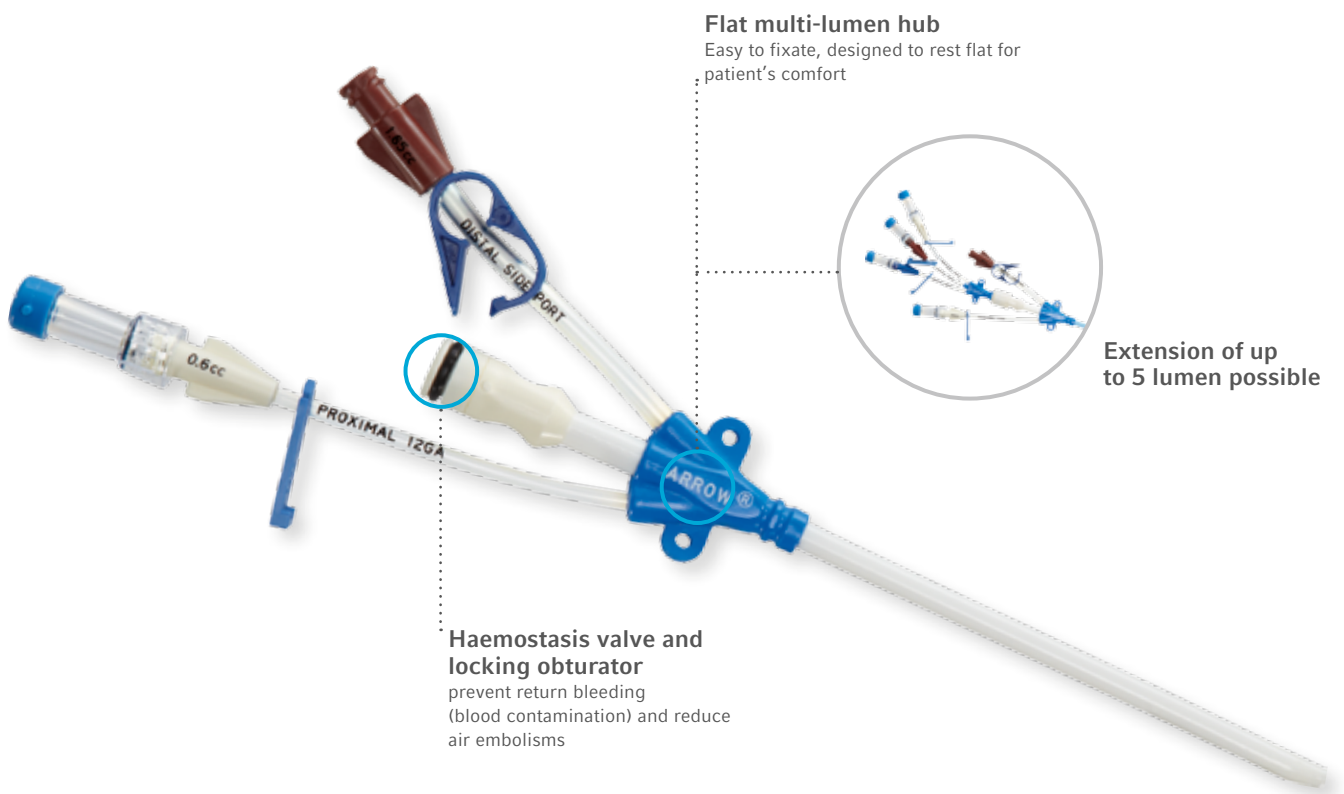

Standard percutaneous sheath introducer sets (PSI)

Single-lumen percutaneous introducer sets

| REF. | INTRODUCER SET | | | | | GUIDEWIRE | | | CANNULA | | SYRINGE | | ACCESSORIES | | QTY | |
|--------------|----------------|--------|----------|-------------------|-----------|-----------|-----------------|---------|---------------------|--|---|-------------------------|---------------------------|---------------|---------------------------|-------------|
| | Ø | LENGTH | MATERIAL | FOR CATHETER SIZE | LATEXFREE | LENGTH | Ø | MARKING | WITH ARROW ADVANCER | INTRODUCER NEEDLE 18 G ¹ / 6.35 CM | 18 G (6.35 CM) OVER 20 G ³ INTRODUCER NEEDLE | RAULERSON 5ML LUER SLIP | STANDARD 5ML LUER SLIP | CONTAMINATION | | ACCESSORIES |
| SI-09600 | 6 Fr. | 10 cm | PUR | 4-6 Fr. | | 45 cm | 0.89 mm (.035") | | | + | | | | A | 5 | 10 |
| SI-09700 | 7 Fr. | 10 cm | PUR | 7 Fr. | | 45 cm | 0.89 mm (.035") | | | + | | | | A | 5 | 10 |
| CI-09803 | 8 Fr. | 10 cm | PUR | 7-7.5 Fr. | | 45 cm | 0.89 mm (.035") | | | + | + | | | | | 10 |
| SI-09808 | 8 Fr. | 10 cm | PUR | 7-7.5 Fr. | | 45 cm | 0.89 mm (.035") | | | + | | | | B | 5 | 10 |
| SI-09880-AG | 8.5 Fr. | 10 cm | AGB PUR | 7-7.5 Fr. | + | 45 cm | 0.89 mm (.035") | | | + | | | | B | 5 | 10 |
| CI-09800 | 8.5 Fr. | 10 cm | PUR | 7-7.5 Fr. | | 45 cm | 0.89 mm (.035") | | | + | | | | | | 10 |
| SI-09803-CV | 8.5 Fr. | 10 cm | PUR | 7-7.5 Fr. | | 45 cm | 0.89 mm (.035") | | | + | | | | B | 9 | 10 |
| SI-09806 | 8.5 Fr. | 10 cm | PUR | 7-7.5 Fr. | | 45 cm | 0.64 mm (.025") | + | + | 1 x 18 G ¹ / 6.35 cm 1 x 20 G ¹ / 3.81 cm | 1 x 20 G (4,45 cm) over 22 G ³ | + | | B | 5 | 10 |
| SI-09870-E | 8.5 Fr. | 10 cm | PUR | 7-7.5 Fr. | | 45 cm | 0.89 mm (.035") | + | + | + | | + | | C | 5 | 10 |
| SI-09875-E | 8.5 Fr. | 10 cm | PUR | 7.5 Fr. | | 45 cm | 0.89 mm (.035") | + | + | + | | + | | D | 5 | 10 |
| SI-09875-ESB | 8.5 Fr. | 10 cm | PUR | 7.5 Fr. | + | 45 cm | 0.89 mm (.035") | + | + | + | | + | | D | 5 | 10 |
| SI-09880 | 8.5 Fr. | 10 cm | PUR | 7-7.5 Fr. | + | 45 cm | 0.89 mm (.035") | | | + | | | | B | 5 | 10 |
| SI-09880-LF | 8.5 Fr. | 10 cm | PUR | 7.5 Fr. | + | 45 cm | 0.89 mm (.035") | | | + | | | | D | 5 | 10 |
| SI-09880-SB | 8.5 Fr. | 10 cm | PUR | 7-7.5 Fr. | + | 45 cm | 0.89 mm (.035") | | | + | | | | B | 5 | 10 |
| SI-09880-SE | 8.5 Fr. | 10 cm | PUR | 7-7.5 Fr. | | 45 cm | 0.89 mm (.035") | + | + | + | | + | | B | 5 | 10 |
| SI-09903-E | 9 Fr. | 10 cm | PUR | 7.5-8 Fr. | + | 45 cm | 0.89 mm (.035") | + | + | + | | + | | D | 5, 6, 7 | 10 |
| AD-09903 | 9 Fr. | 10 cm | PUR | 7-8 Fr. | + | 45 cm | 0.89 mm (.035") | + | + | + | | | + | | 6, 7 | 10 |
| AD-09903-S | 9 Fr. | 10 cm | PUR | 7-8 Fr. | + | | | | | + | | | + | B | 6, 7 | 10 |
| BR-09903-S | 9 Fr. | 10 cm | PUR | 7.5-8 Fr. | + | 45 cm | 0.89 mm (.035") | | | + | | | 1 x 5ml LS 1 x 10ml LS | D | 6, 3x7, 8, 10, 11, 12, 13 | 10 |

¹ XTW = Extra Thin Wall ² TW = Thin Wall ³ RW = Standard Wall

Contamination Shield

A = Cath-Gard / 30,5 cm / 5-6 Fr. / Connection Standard

B = Cath-Gard / 80 cm / 7-7,5 Fr. / Connection Standard

C = Cath-Gard / 80 cm / 7 Fr. / Connection TwistLock Adapter blue

D = Cath-Gard / 80 cm / 7,5 Fr. / Connection TwistLock Adapter yellow

In every set is an Obturator 8 Fr.

5 = 3 x Gauze Pads

6 = 1 x Dust Cap: Non-Vented

7 = 1 x Stopcock: 4-way High-Flow

8 = 1 x scalpel #11

9 = 1 x Tape: Sterile

10 = Injection Needle: 22G / 3,81cm

11 = Injection Needle: 25G / 2,5cm

12 = Suture 2-0 Silk with Straight Needle

13 = Dressing: OpSite 1 5-1/2" x 4" (14 x 10 cm)

Central Venous Access Set with Integral Hemostasis Valve

MAC – Multi-lumen access catheter

| REF. | CATHETER | | | | GUIDEWIRE | | | | | CANNULA | | ACCESSORIES | | | QTY |
|----------|----------|---------|----------|-------------------|-----------|-----------------|----------------|---------|---------------------|---------|-------------------|--------------------------|-----------|-------------|-----|
| | Ø | LENGTH | MATERIAL | FOR CATHETER SIZE | LENGTH | Ø | TIP | MARKING | REFERENCE | LENGTH | Ø | CONTAMINATION PROTECTION | OBTURATOR | ACCESSORIES | |
| SI-11142 | 14 Fr. | 10 cm | PUR | 7-8 Fr. | 45 cm | 0.89 mm (.035") | J-tip/straight | + | With Arrow advancer | 6.35 cm | 18 G ¹ | + | 8 Fr. | + | 5 |
| SI-11242 | 14 Fr. | 11.5 cm | PUR | 7-7.5 Fr. | 45 cm | 0.89 mm (.035") | J-tip/straight | + | With Arrow advancer | 6.35 cm | 18 G ¹ | + | 8 Fr. | + | 5 |
| SI-21142 | 14 Fr. | 10 cm | PUR A+g | 7-8 Fr. | 45 cm | 0.89 mm (.035") | J-tip/straight | + | With Arrow advancer | 6.35 cm | 18 G ¹ | + | 8 Fr. | + | 5 |

Contamination protection

Cath-Gard 80 cm with Tuohy-Borst adapter

Accessories

1 x pressure transducer, 1 x Arrow Raulerson syringe 5 ml, 3 x gauze pads 4" x 4", 1 x unvented closure cap, 1 x vented closure cap, 1 x Stopcock: 4-way High-Flow

CVC for MAC introducer systems



| ART. NO. | CATHETER | | | | | | QTY |
|----------|----------|-------|-----------------|---------------|--------|----------|-----|
| | LUMEN | Ø | LENGTH WITH MAC | INNER LUMEN G | DESIGN | MATERIAL | |
| ML-00701 | 1 | 7 Fr. | 14 cm | | | PUR | 5 |
| ML-00702 | 2 | 7 Fr. | 16 cm | 16D-16P | C | PUR | 5 |
| ML-00703 | 3 | 7 Fr. | 16 cm | 16D-18M-18P | H | PUR | 5 |

Lumen design Ga.

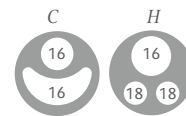

MAC Flow Rates

| LUMEN | FLOW RATE (ML/HR) ¹ |
|------------------------------------|--------------------------------|
| Distal (9 Fr.) no catheter | 29,920 |
| Distal (9 Fr.) with 8 Fr. catheter | 12,180 |
| Distal (9 Fr.) with 7 Fr. catheter | 19,810 |
| Proximal (12 Ga.) no catheter | 9,340 |

Accessories

Cath-Gard Catheter Contamination Shield

| ART. NO. | FOR CATHETER SIZE | | CONNECTION | COLOUR | VE |
|---|-------------------|------------------|-------------------------|--------|----|
| | ART. NO. | LENGTH | | | |
|  | SA-09847 | 4-7 Fr., 80 cm | Tuohy-Borst | Blue | 10 |
|  | ST-09807 | 7-7.5 Fr., 80 cm | Tuohy-Borst | Blue | 25 |
|  | EU-00001-ST | 5-6 Fr., 80 cm | TwistLock & Tuohy-Borst | Green | 10 |
|  | ST-09880 | 7-7.5 Fr., 80 cm | No lock | Blue | 25 |
|  | ST-09870 | 7 Fr., 80 cm | TwistLock | Blue | 25 |
|  | ST-09875 | 7-7.5 Fr., 80 cm | TwistLock | Yellow | 25 |

Hemostasis Valve Obturator 8 Fr.

| ART. NO. | SIZE | VE |
|----------|-------|----|
| AO-09000 | 8 Fr. | 10 |

¹ Based on 100 cm head height gravity saline flow rates. Flow rates would be higher with a rapid infuser or pressure bag.

Teleflex is a global provider of medical technologies designed to improve the health and quality of people's lives. We apply purpose driven innovation – a relentless pursuit of identifying unmet clinical needs – to benefit patients and health-care providers. Our portfolio is diverse, with solutions in the fields of vascular and interventional access, surgical, anesthesia, cardiac care, urology, emergency medicine and respiratory care. Teleflex employees worldwide are united in the understanding that what we do every day makes a difference. For more information, please visit teleflex.com.

Teleflex is the home of Arrow, Deknatel, Hudson RCI, LMA, Pilling, Rüsçh, and Weck – trusted brands united by a common sense of purpose.

Corporate Office

Phone +1 610 225 6800, 550 E. Swedesford Road, Suite 400, Wayne, PA 19087, USA

Regional Offices

United States: Phone +1 919 544 8000, Toll Free 866 246 6990, cs@teleflex.com, 3015 Carrington Mill Boulevard, Morrisville, NC 27560, USA

Latin America: Phone +1 919 433 4999, la.cs@teleflex.com, 3015 Carrington Mill Boulevard, Morrisville, NC 27560, USA

International: Phone +353 (0)9 06 46 08 00, orders.intl@teleflex.com, Teleflex Medical Europe Ltd., IDA Business and Technology Park, Dublin Road, Athlone, Co Westmeath, Ireland

Australia 1300 360 226

Austria +43 (0)1 402 47 72

Belgium +32 (0)2 333 24 60

Canada +1 (0)800 387 9699

China (Shanghai) +86 (0)21 6163 0965

China (Beijing) +86 (0)10 6418 5699

Czech Republic +420 (0)495 759 111

France +33 (0)5 62 18 79 40

Germany +49 (0)7151 406 0

Greece +30 210 67 77 717

India +91 (0)44 2836 5040

Italy +39 0362 58911

Japan +81 (0)3 6632 3600

Korea +82 2 536 7550

Mexico +52 55 5002 3500

Netherlands +31 (0)88 00 215 00

New Zealand 0800 601 100

Portugal +351 22 541 90 85

Poland 0048 22 4624032

Singapore (SEA non-direct sales countries) +65 6439 3000

Slovak Republic +421 (0)3377 254 28

South Africa +27 (0)11 807 4887

Spain +34 918 300 451

Switzerland +41 (0)31 818 40 90

United Kingdom +44 (0)1494 53 27 61

**For more information,
please visit teleflex.com.**

Teleflex, the Teleflex logo, Arrow, Arrow Advancer, Cath-Gard, Deknatel, Hudson RCI, LMA, OpSite, Pilling, Quickflash, Rüsçh, TwistLock, and Weck are trademarks or registered trademarks of Teleflex Incorporated or its affiliates, in the U.S. and/or other countries.

Information in this material is not a substitute for the product Instructions for Use. Not all products may be available in all countries. Please contact your local representative. Revised: 07/2017. © 2017 Teleflex Incorporated. All rights reserved.